

Product Code	Description
JC2C-DMB-W	4A Bell Switch with "Do Not Disturb" + "Make Up Room" Indicator



JC2C-DMB-W-LWH



Product back view

Technical Specification

- Rated Voltage: 250VAC 50/60Hz
- Rated Current: 4A (Bell Switch)
- Indicator: Neon (Red, Green)
- Recommended wire size: 0.5mm² - 1.5mm²
- Fix Centre: 60.3 mm
- Fix Screw: M3.5 x 0.6 x 25mm±

With Lavina '95 Frame: JC1401

- Dimensions: 95x95x10mm (WxHxD)
- Mounting box: >35mm depth
 - J1040, flush mounting, plastic
74.5 x 74.5 x 42mm (W x H x D)
 - M1050, flush mounting, metal
75.5 x 64 x 50mm (W x H x D)
- Comply to Standards:
IEC 60669, GB16915.1

Product Dimensions (mm)

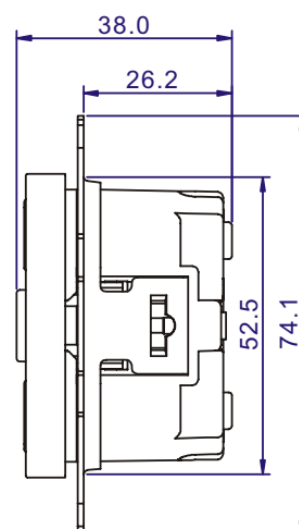
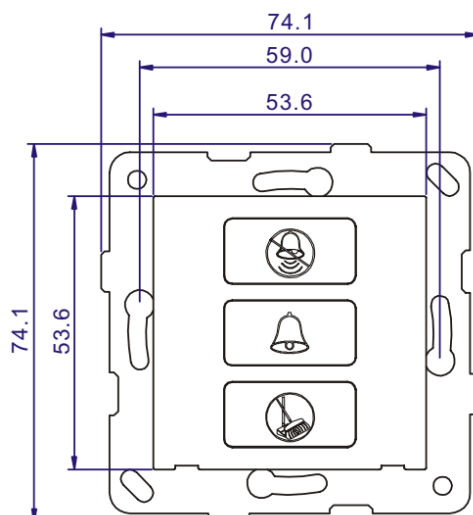

Single-gang Assembly

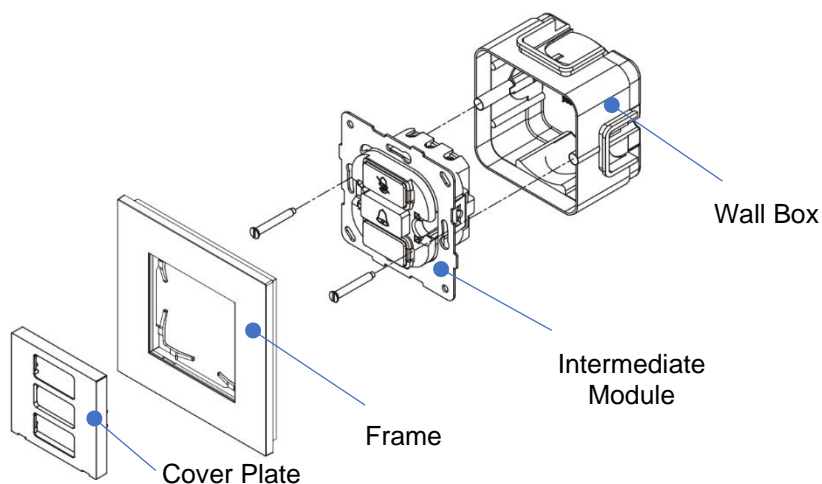

Connection Diagram



(with 2-Gang, 2-Way Switch for DND/MUR)

L1-N1: Make-up Room Indicator

L2-N2: Do Not Disturb Indicator

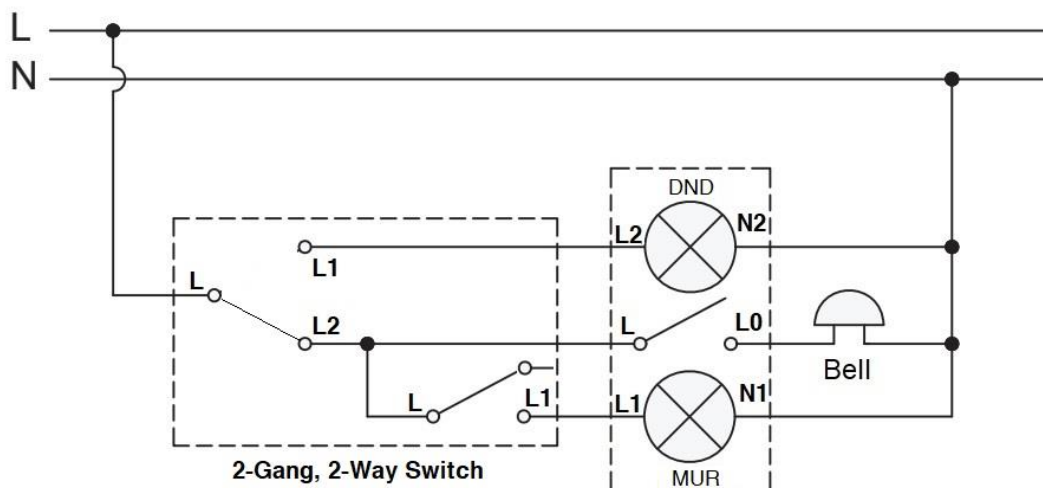
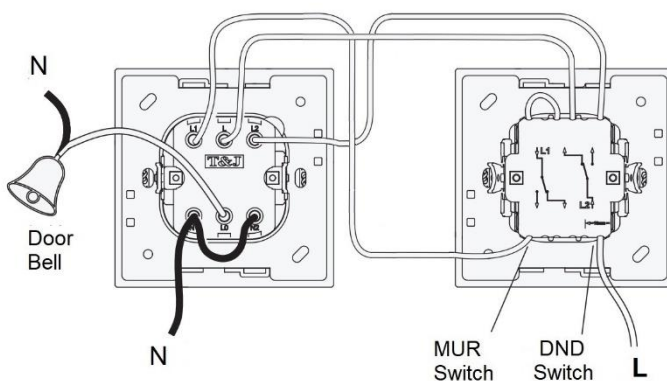
L-L0: Bell-push switch contact

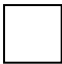

Product Code	Colour
JC2C-DMB-W-LWH	 Matt White
JC2C-DMB-W-LBL	 Matt Black
For other colours, please contact T&J Sales representative	